

Installing the Danalock on a door with a Euro cylinder

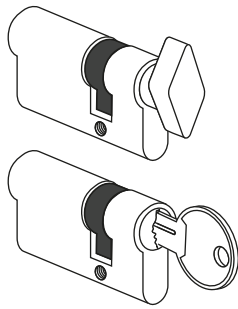

To mount the Danalock on a door with an euro cylinder you will have to exchange it.

The cylinder could look like the ones to the left, or it could be a completely different model, these illustrations are just examples.

First you have to order a new cylinder with your Danalock.
To find out what size of cylinder to order, follow these steps:

1. Dismount you existing cylinder.
You do this by unscrewing the screw in the door that holds the cylinder.

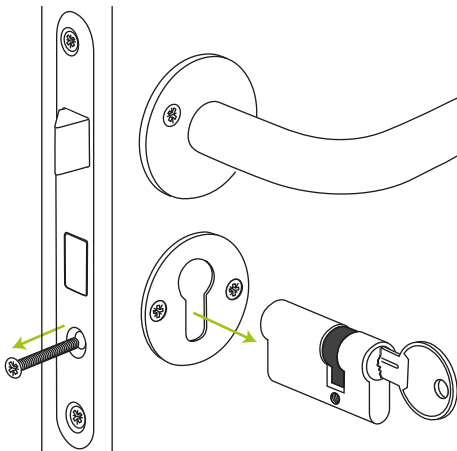

2. Now you will have to measure the cylinder. You measure the cylinder as shown here:

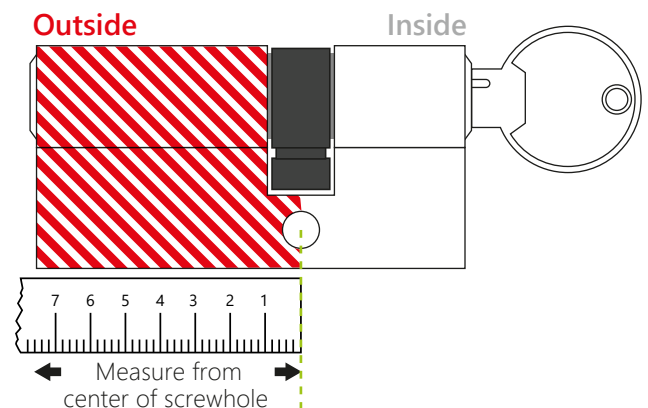

3. Choose the cylinder in our web shop that comes closest to your existing cylinder

Choose one of these fixed sizes:

- 25 x 30 mm
- 25 x 40 mm
- 25 x 45 mm
- 25 x 50 mm

4. Follow the mounting guide in the Danalock package or on our website danalock.com/danalock-v3-euro-guide to mount the Danalock on your door.